

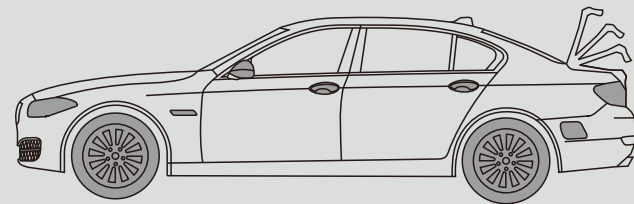

Installation Process

Electric tail gate lift system



NOTE

Note for electronic tail gate installation

1. For the sake of safety, and ensure that the product of normal use, please ask the sales of the products of professional personnel to install, do not to remove the machine, lest cause damage of the machine has the accident.
2. Loading before starting the engine, check the car instrument, according to the function keys inside the car is normal operation, the car inside and outside surface had scratched phenomenon, if there are any problems, report to the customer in time.
3. Check whether the tail door open/close to normal, check whether the lamp is normal
4. Turn off the engine, and prepare related tools
5. Please remove installation personnel carries on metal objects, and other hard objects to prevent in the process of dismantling the car seat or interior damage, etc.
6. The installation process and pay attention to remove the car component to put good, avoid the scraping the float inside the instrument desk, when wiring clutter left by the timely processing, don't stay in the car, must be properly insulating joint, to avoid short circuit.
7. According to our wiring way, to avoid running in the process of impact to the car's moving parts, such as steering wheel drive shaft, the accelerator and brake pedal until the vehicle control unit, the harness after next go line needs to be fixed, to avoid any loose.
8. Root tree our connection mode, please pick up the wiring harness(pls be care for the position of ground wire)
9. Don't press the plug connected fuses , accessories when it is on, in order to avoid damage to the host or attachment plug

▲ After the installation, close the trunk by manual, so that the system initialization

Wire definition

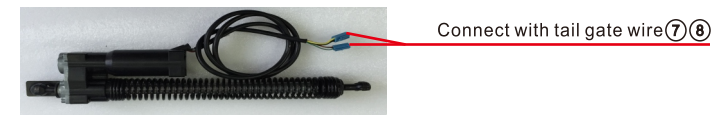
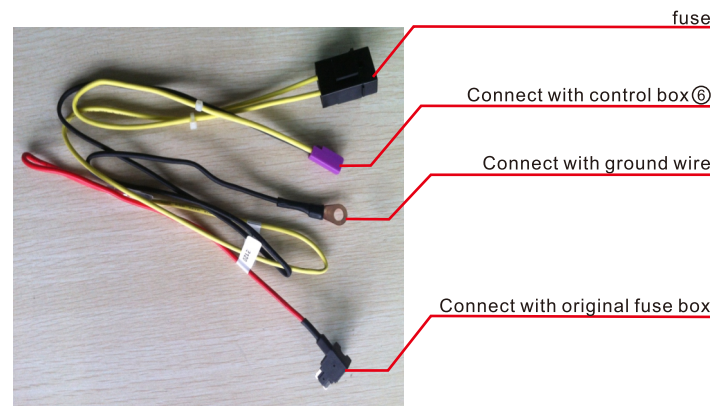
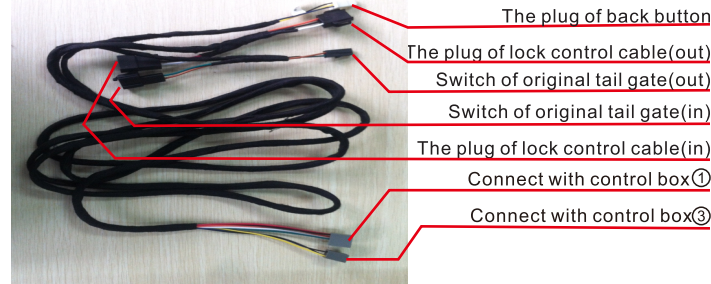

Wire definition

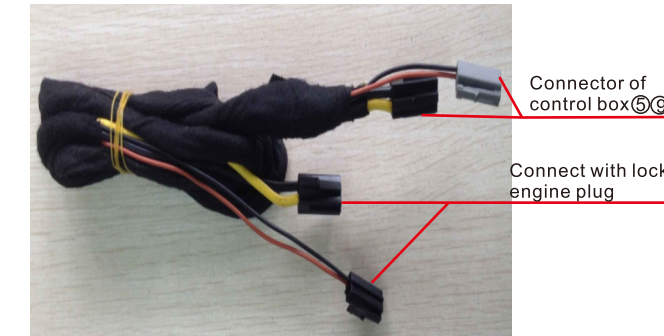

The front side of control box connector

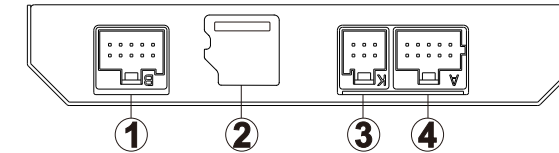

The back side of control box connector

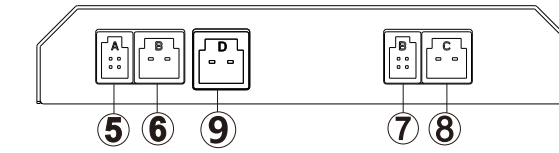

Installation steps

1. The picture before installation
2. Remove trim panel, first remove two pressure angle of left and right in the top
3. Remove tripod
4. Remove the fix bracket of tripod
5. The wire of back button should walk wire along rotating beam of tail gate in the left side, then install the plastic sheath
6. Pry the lower edge trim panel with plastic plate
7. Pry the top edge trim panel with plastic plate
8. The picture after remove interior trim panel
9. Remove spare tire cover of rear tail box, power supply from original car, take out spare tire.
10. Pls remove four pressure angle before remove trim panel of rear tail box
11. Remove the fender in the left side
12. The bracket in red circle includes spin riveting bracket in the front and bracket fix plate in the back side fixing and locking with skidproofM6 screw
13. The picture after fix tail gate lift. The left side is the place to install bracket. screw will be subject to object, motor side should under adown
14. As picture shows, the lock control switch wire connect with connection terminals, then install back to original position
15. The lock control switch wire connect with original plug the picture shows the walk wire position of lock control wire and tail gate button wire

Installation steps

16. Pls drill two holes in front metal plate and walk wire, then install our electric lock as hole position
17. Pls install our screw with electric lock
18. The position of electric lock's drive box can be placed flexibly, the drive wire is in the left side
19. According the actual space to install power source of the electric lock
20. Opening holes on the drawing with a perforated template
21. Remove the ventilation cover and install the control box on it
22. The position to install the control box
23. The control box's cable connection
24. Get power from right side fuse box in the tail gate
25. The picture after installation
26. Unlock rope and lock rope are connected by card slot and there should be crossed connected.